

# Sankosha – Your Perfect Match

## Shirt Presses of World Standard



**LP-690**

Single Collar/Cuff Press



**LP-590**

Single Buck Shirt Press

### ■ World Standard of Finishing Quality

Second-to-none quality finishing by industry innovator

### ■ High Productivity with Power

Up to 60 quality finishing per hour by 1 person

### ■ Versatile Body with Side Expanders

For wide variety of shirts - from Small to XXXL

### ■ Sleeve Arms Up/Down Function

Great for any type of shirt design – European or American

<http://www.sankosha-mfg.com>

Visit our web site for valuable Information  
for your business expansion.



SANKOSHA MANUFACTURING CO., LTD.  
988 Kanoya, Hachioji, Tokyo 193-0815, Japan  
Tel: +81 42 621 1182 Fax: +81 42 620 0751

# LP-series Valued Features

Tensioning Collar Press  
(also good for Placket extension)

Pressure-absorbing  
Cuff Press Pads

Best Fit  
Side Expanders

Big Size Front &  
Rear Press Heads

LP-690

Powerful Press  
Cylinders

Sleeve Arms  
Up/Down Function

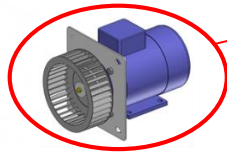

High Power  
Blower Motor

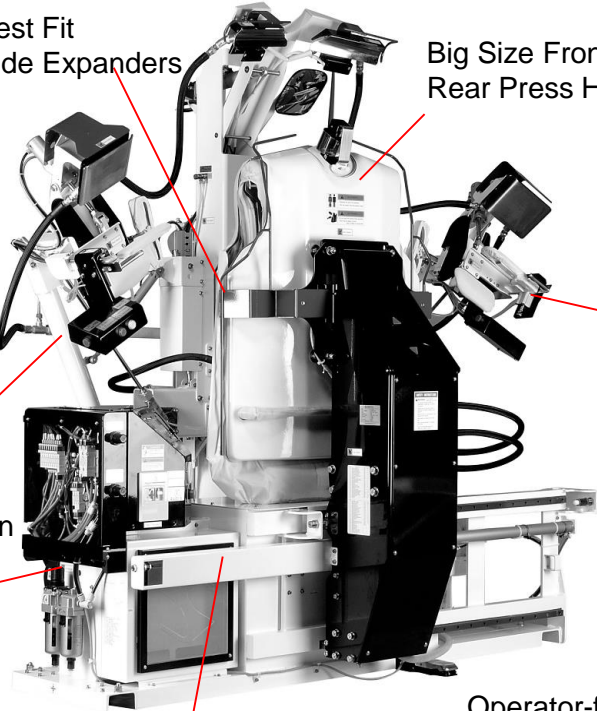

Auto  
Angle  
Cuff  
Press

LP-590

Big-size Radiator for  
Powerful Hot-air

Operator-friendly  
Ergonomic Operation

## Highest Quality Safety Ratings

### Specifications

Model		LP-590E	LP-690E-V3
Power Requirement		3 phase 400V 50Hz	Single phase 230V
Power Consumption		1.9 kW	0.03 kW
Air	Air Pressure	0.6 MPa	0.6 MPa
	Air Consumption	53 litre / cycle	23 litre / cycle
	Air Pipe	3/8"	3/8"
Steam	Steam Pressure	0.6 MPa	0.6 MPa
	Steam Consumption	50 kg / h	10 kg / h
	Steam Pipe	In 3/4", Out 1/2" x3	1/2"
Net Weight		690 kg	210 kg
Dimensions W x D x H (mm)		2470 x 1200 x 2000	710 x 1000 x 1620
Installation Dimensions (mm)			

Features and specifications are subject to change without notice.

### System Configurations

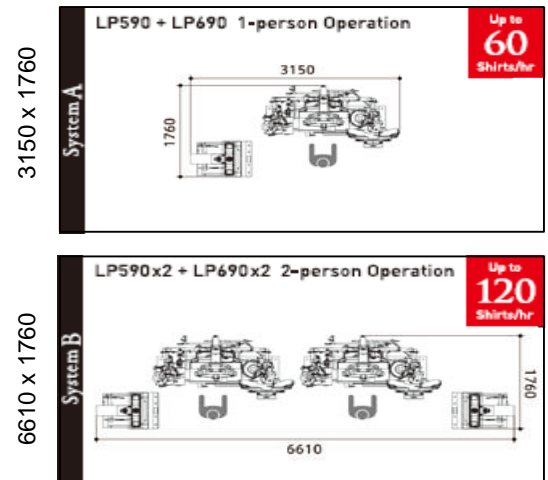

### Options



LP-685

Double Collar/Cuff  
Press with Vacuum  
(Tensioning Pads)



LP-550  
Small Buck

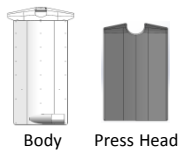

LP-570  
Slim Buck

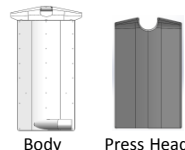

LP-590  
Large Buck

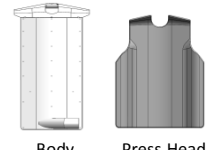

Distributed by: